

LINEAR Light

Architectural led lamp, the ideal solution for offices and conference rooms.
 High efficiency LED working with dark light optics (60,000) or opaline (120,000).
 Different installation options are available: directly on the ceiling, on the wall or suspended.

Lampada architettonica, ideale per uffici e meeting room.
 Led ad alta efficienza che lavora con ottica dark light (60°) o su opalina (120°)
 Possono essere installate a soffitto, a muro, oppure sospese.

Architektonische LED-Lampe, die ideale Lösung für Büros und Meetingräume.
 Hocheffiziente Leds, die mit Dark-Light-Optik (60°) oder auf Opalin (120°) arbeiten
 Man kann auswählen, ob die Lampe direkt an der Decke, an der Wand oder hängend installiert wird.

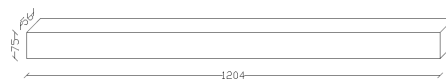

Code	Watt	Color Temp(K)	Size (AXBXCmm)	Support	Lumen (±5%)	N.W/pc (kgs)	Q'ty/CTN
RL12036AWX	36W	3000	1204X56X75	Yes	3700lm	2.75	6PCS
RL12036ANX	36W	4000	1204X56X75	Yes	3950lm	2.75	6PCS
RL12036AWX-E	36W	3000	1204X56X75	Yes	3700lm	2.75	6PCS
RL12036ANX-E	36W	4000	1204X56X75	Yes	3950lm	2.75	6PCS
RL12036AWX-D010	36W	3000	1204X56X75	Yes	3700lm	2.75	6PCS
RL12036ANX-D010	36W	4000	1204X56X75	Yes	3950lm	2.75	6PCS
RL12036AWX-DD	36W	3000	1204X56X75	Yes	3700lm	2.75	6PCS
RL12036ANX-DD	36W	4000	1204X56X75	Yes	3950lm	2.75	6PCS

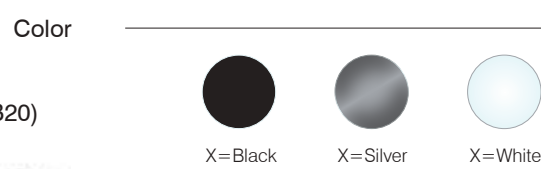
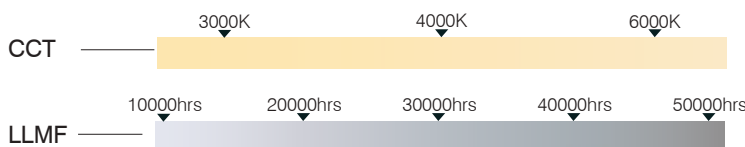

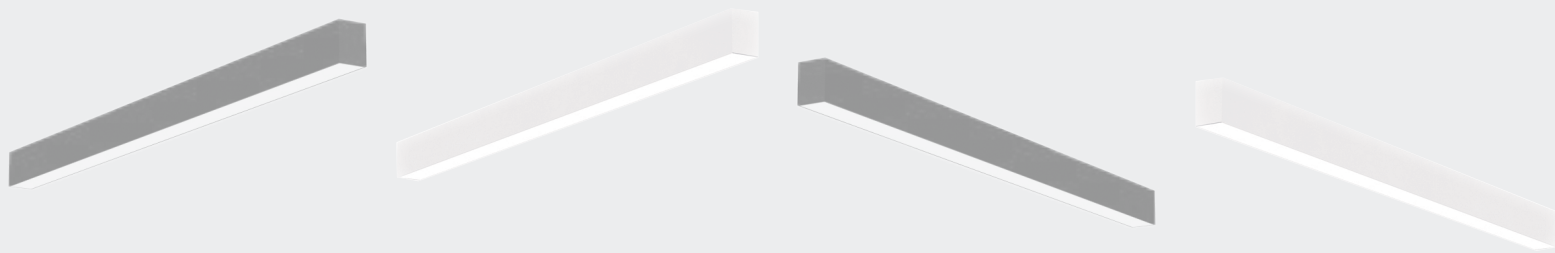

LINEARLight

Architectural led lamp, the ideal solution for offices and conference rooms.
 High efficiency LED working with dark light optics (60,000) or opaline (120,000).
 Different installation options are available: directly on the ceiling, on the wall or suspended.

Lampada architettonica, ideale per uffici e meeting room.
 Led ad alta efficienza che lavora con ottica dark light (60°) o su opalina (120°)
 Possono essere installate a soffitto, a muro, oppure sospese.

Architektonische LED-Lampe, die ideale Lösung für Büros und Meetingräume.
 Hocheffiziente Leds, die mit Dark-Light-Optik (60°) oder auf Opalin (120°) arbeiten
 Man kann auswählen, ob die Lampe direkt an der Decke, an der Wand oder hängend installiert wird.

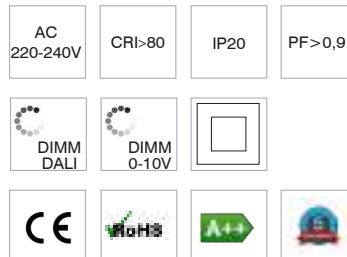
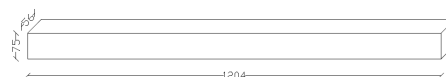

Code	Watt	Color Temp(K)	Size (AXBXCmm)	Support	Lumen (±5%)	N.W/pc (kgs)	Q'ty/CTN
RL12050AWX	50W	3000	1204X56X75	Yes	5000lm	2.75	6PCS
RL12050ANX	50W	4000	1204X56X75	Yes	5200lm	2.75	6PCS
RL12050AWX-D010	50W	3000	1204X56X75	Yes	5000lm	2.75	6PCS
RL12050ANX-D010	50W	4000	1204X56X75	Yes	5200lm	2.75	6PCS
RL12050AWX-DD	50W	3000	1204X56X75	Yes	5000lm	2.75	6PCS
RL12050ANX-DD	50W	4000	1204X56X75	Yes	5200lm	2.75	6PCS

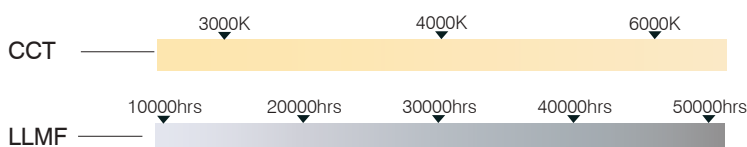

Color



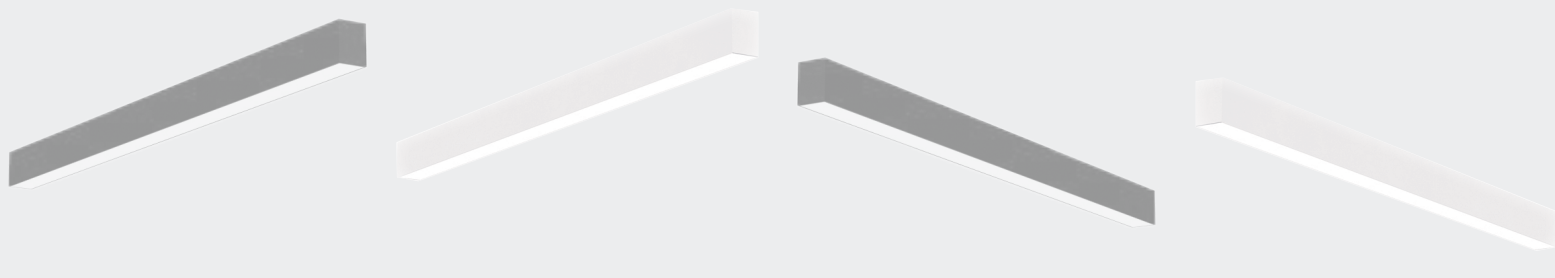

LINEARLight

Architectural led lamp, the ideal solution for offices and conference rooms.
 High efficiency LED working with dark light optics (60,000) or opaline (120,000).
 Different installation options are available: directly on the ceiling, on the wall or suspended.

Lampada architettonica, ideale per uffici e meeting room.
 Led ad alta efficienza che lavora con ottica dark light (60°) o su opalina (120°)
 Possono essere installate a soffitto, a muro, oppure sospese.

Architektonische LED-Lampe, die ideale Lösung für Büros und Meetingräume.
 Hocheffiziente Leds, die mit Dark-Light-Optik (60°) oder auf Opalin (120°) arbeiten
 Man kann auswählen, ob die Lampe direkt an der Decke, an der Wand oder hängend installiert wird.

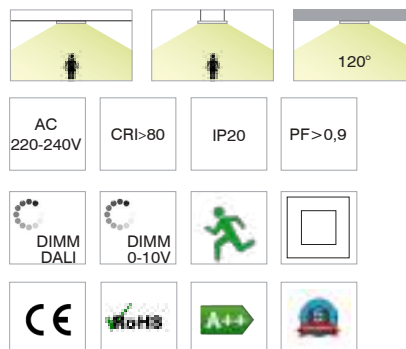
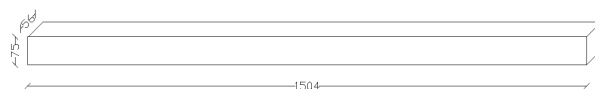

Code	Watt	Color Temp(K)	Size (AXBXCmm)	Support	Lumen (±5%)	N.W/pc (kgs)	Q'ty/CTN
RL15042AWX	42W	3000	1504X56X75	Yes	4000lm	3.35	6PCS
RL15042ANX	42W	4000	1504X56X75	Yes	4600lm	3.35	6PCS
RL15042AWX-E	42W	3000	1504X56X75	Yes	4000lm	3.35	6PCS
RL15042ANX-E	42W	4000	1504X56X75	Yes	4600lm	3.35	6PCS
RL15042AWX-D010	42W	3000	1504X56X75	Yes	4000lm	3.35	6PCS
RL15042ANX-D010	42W	4000	1504X56X75	Yes	4600lm	3.35	6PCS
RL15042AWX-DD	42W	3000	1504X56X75	Yes	4000lm	3.35	6PCS
RL15042ANX-DD	42W	4000	1504X56X75	Yes	4600lm	3.35	6PCS

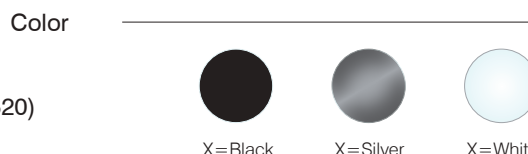
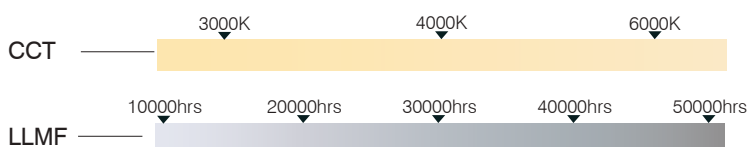

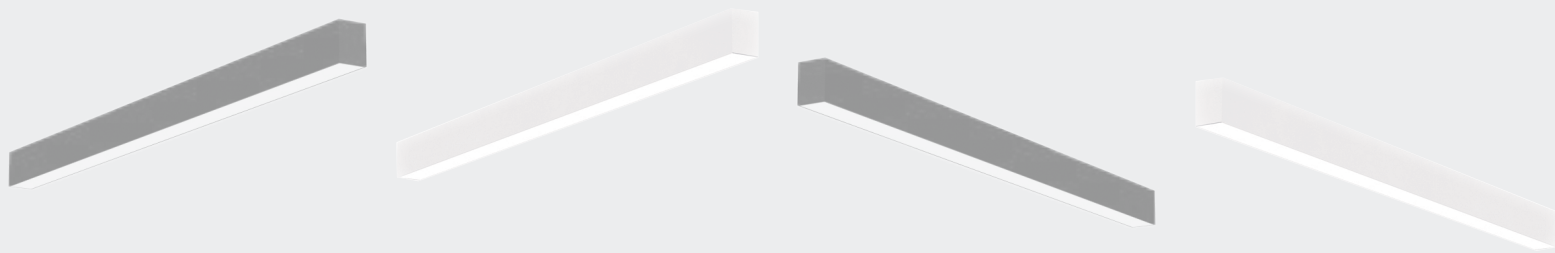

LINEAR Light

Architectural led lamp, the ideal solution for offices and conference rooms.
 High efficiency LED working with dark light optics (60,000) or opaline (120,000).
 Different installation options are available: directly on the ceiling, on the wall or suspended.

Lampada architettonica, ideale per uffici e meeting room.
 Led ad alta efficienza che lavora con ottica dark light (60°) o su opalina (120°)
 Possono essere installate a soffitto, a muro, oppure sospese.

Architektonische LED-Lampe, die ideale Lösung für Büros und Meetingräume.
 Hocheffiziente Leds, die mit Dark-Light-Optik (60°) oder auf Opalin (120°) arbeiten
 Man kann auswählen, ob die Lampe direkt an der Decke, an der Wand oder hängend installiert wird.

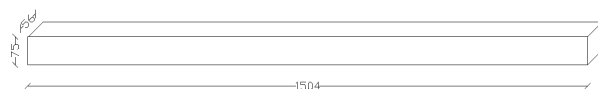

AC 220-240V	CRI>80	IP20	PF>0,9
DIMM DALI	DIMM 0-10V		
CE	RoHS	A++	

Code	Watt	Color Temp(K)	Size (AXBXCmm)	Support	Lumen (±5%)	N.W/pc (kgs)	Q'ty/CTN
RL15060AWX	60W	3000	1504X56X75	Yes	6000lm	3.35	6PCS
RL15060ANX	60W	4000	1504X56X75	Yes	6200lm	3.35	6PCS
RL15060AWX-D010	60W	3000	1504X56X75	Yes	6000lm	3.35	6PCS
RL15060ANX-D010	60W	4000	1504X56X75	Yes	6200lm	3.35	6PCS
RL15060AWX-DD	60W	3000	1504X56X75	Yes	6000lm	3.35	6PCS
RL15060ANX-DD	60W	4000	1504X56X75	Yes	6200lm	3.35	6PCS

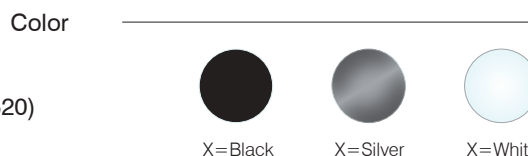
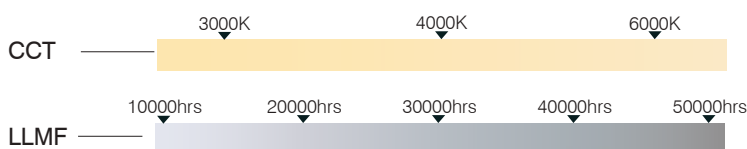

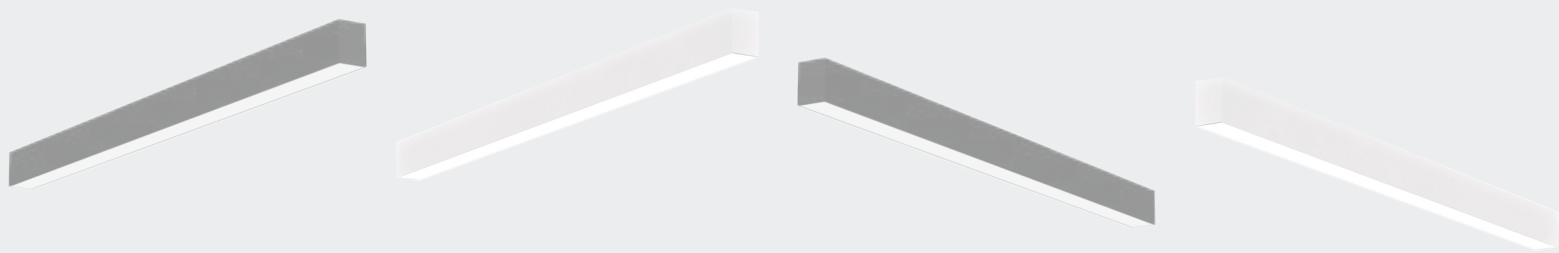

LINEAR Light

EMERGENCY

Power	3W
Rated Input Voltage(V)	AC230V
Frequency	50/60Hz
Input Voltage	AC200-240V
Total load wattage	3W±0.5W
Rated input Current	≤0.023A
Battery	6.4V 1500mAh (LiFePO4)
Lifetime	Over 2000 cycles
Battery duration	≥3hrs
Charge Period	≤24hrs
Emergency switching time	≤ 1s

INSTALLATION

For the product with Slide Switch of CCT selection, please select the CCT (WW/CW/DL) before installation.

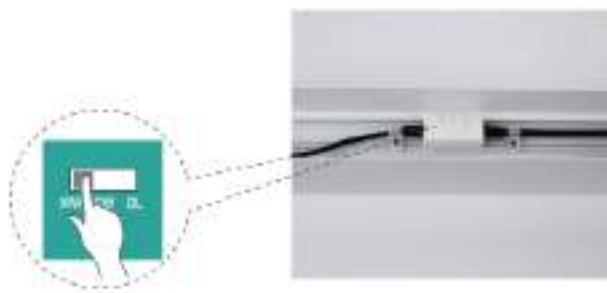

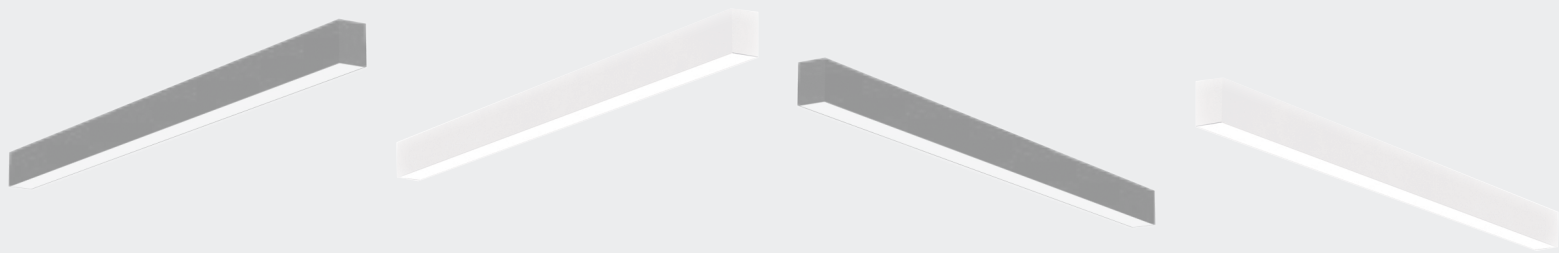

LINEAR Light

SUSPENDED INSTALLATION

STEP 1

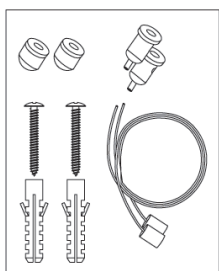

Fix the holders of suspending ropes on the ceiling.

STEP 2

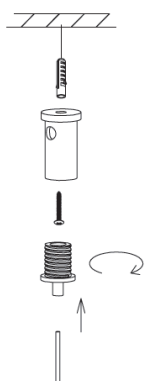

Keep the proper distance of the 2pcs suspending ropes as below table.

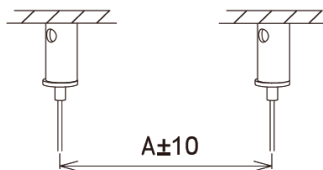

Model	A±10
1200mm	1176mm
1500mm	1476mm

STEP 3

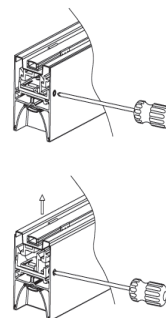

Press the connector, take out the ceiling plate.

STEP 4

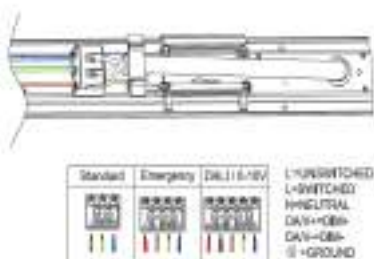

Connect the AC wires.

STEP 5



Connect AC plug, fix the safety rope, put ceiling plate into the fixture, make sure the connector hook hangs the ceiling plate tightly.

STEP 6



Fix the suspending accessories on the lamp.

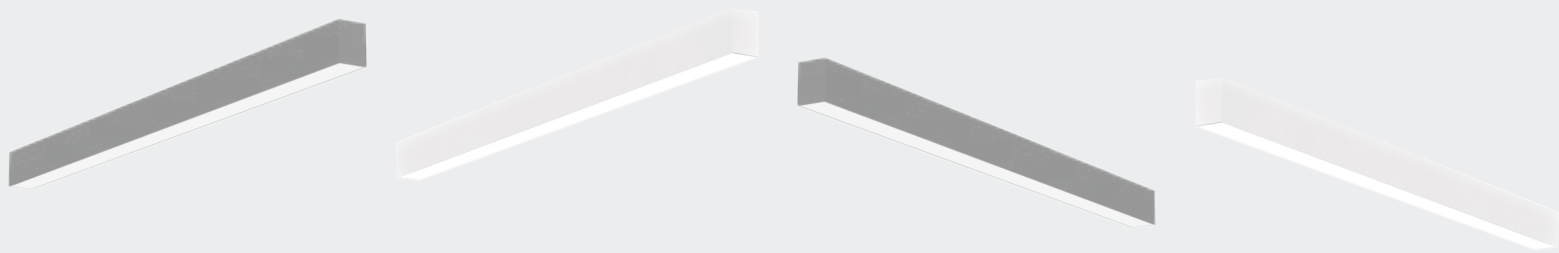

LINEAR Light

SURFACE MOUNTED INSTALLATION

STEP 1



Knock the plastic anchors into ceiling.

STEP 3

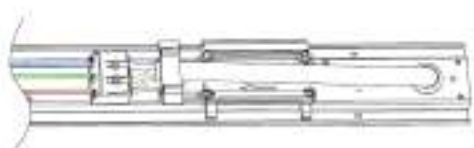

Standard	Emergency	DALE / 0-10V
L=UNSWITCHED N=NEUTRAL DA/N=DIM+ DB/V=DIM- G=GROUND		

Connect the AC wires.

STEP 2

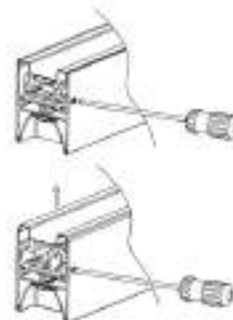

Press the connectors, take out the ceiling plate.

STEP 4



Fix the ceiling plate on the ceiling.

STEP 5

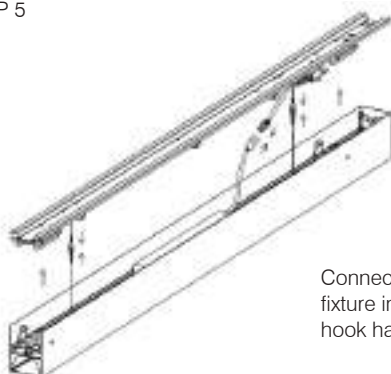

Connect AC plug, fix the safety rope, put the fixture into ceiling plate, make sure the connector hook hangs the ceiling plate tightly.

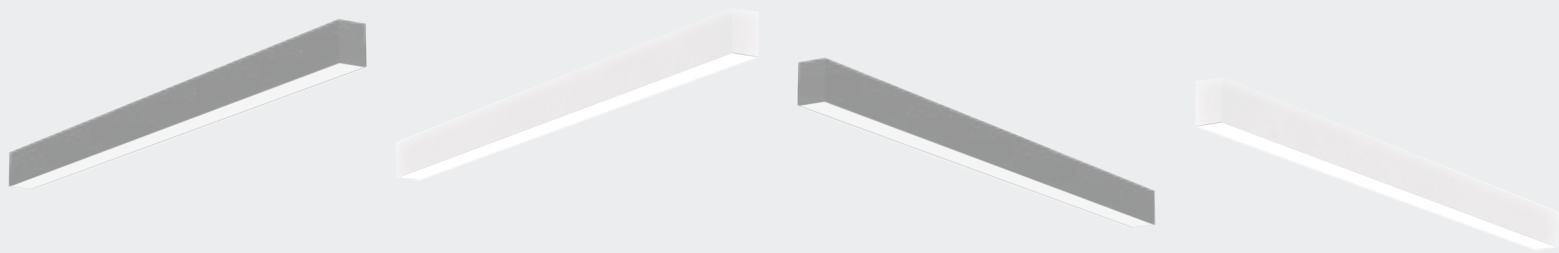

LINEAR Light

WALL MOUNTED INSTALLATION

STEP 1

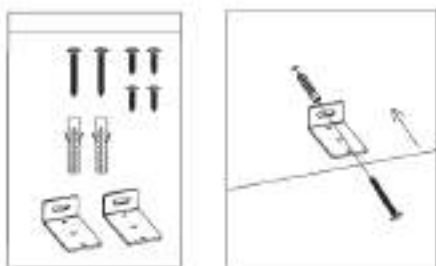

Knock the plastic anchors into the wall, fix the wall plate on the wall.

STEP 3



Connect the AC wires.

STEP 5

STEP 2

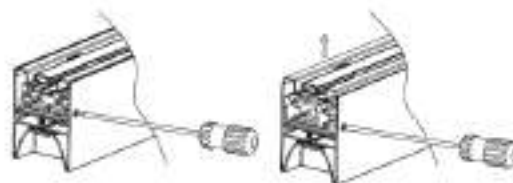

Press the connectors, take out the ceiling plate.

STEP 4



Fix the ceiling plate on the wall plate.

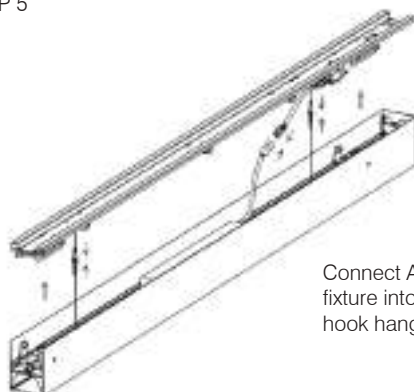

Connect AC plug, fix the safety rope, put the fixture into ceiling plate, make sure the connector hook hangs the ceiling plate tightly.