

Entry /ECO

Standard /STD

Professional/PROO

DM & OEM

Intelligent/INT



STD
Specifications



LED GRILLE LAMP
GL-P Series



 **RL Europe**
Your partner in LED



Introduction

The Grille light is direct lighting with lower anti-glare design. Adopt high lumen SMD chip and special lens which provide high light efficiency and uniform light output. It offers the ideal combination of stylish design and optimum performance for both task and general lighting.

Features

- Direct lighting design, a perfect replacement of traditional grill lamp
- Strong structure design with 23.5mm thickness
- Anti-glare design, UGR<19
- High lumen efficiency, 130lm/w
- Beam angle 80°
- IP40/1K06
- Triac/0-10V/Dali dimming
- External driver

Application Areas

Office & school lighting: office room, meeting room, classroom etc.
Commercial lighting: shopping mall, supermarket, retailer shops etc.
Other situations: hospital, laboratory, dust-free workshop etc.

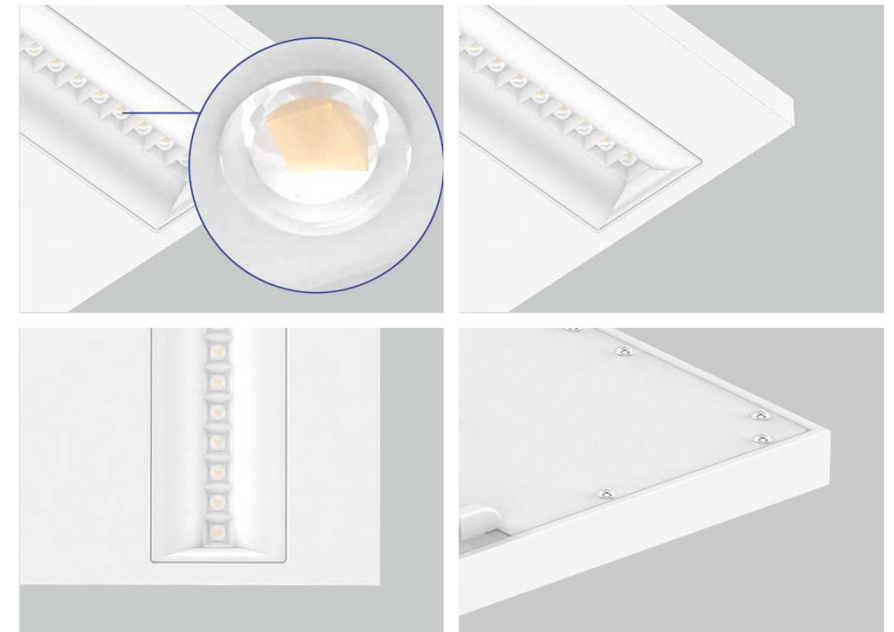

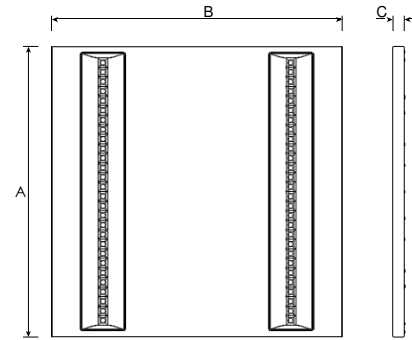
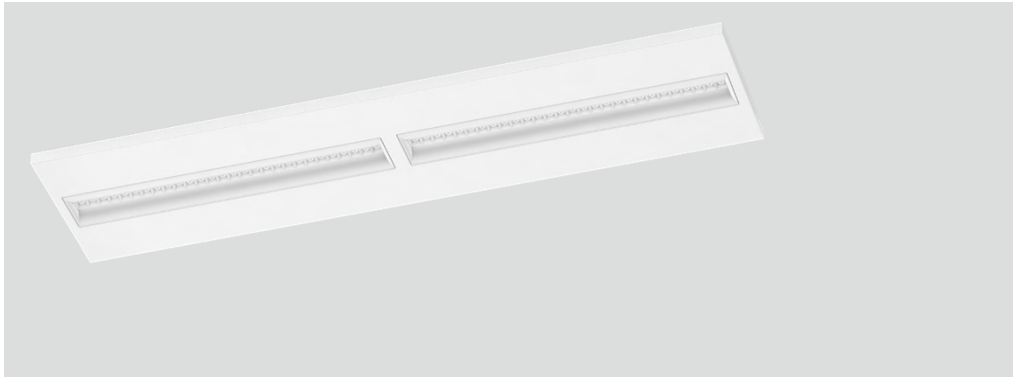

Technical Data Sheet

Code No.	GL6060-35W-P	GL6262-35W-P	GL30120-35W-P	GL60120-60W-P
Dimension(mm)	595*595*23.5	620*620*23.5	295*1195*23.5	595*1195*23.5
Cutout (mm)	555*555	580*580	255*1155	555*1155
Watt(W)	35W			60W
Rated Input Voltage(V)	AC230V			
Input Voltage(V)	AC220-240V			
LED Module Input	-			
Light Source	SMD			
SDCM	< 6			
CCT(K)	3000K / 4000K / 5000K / 5700K			
CCT Selection DIP Switch	No			
Luminous Flux (lm) ± 5%	Non-DIM DIM	1-CCT	4250-4450	
			4080-4280	
	Non-DIM DIM	3-CCT	-	
			-	
CRI	≥80			
Beam Angle (°)	80°			
UGR	<19			
LED Driver	Built-out			
Dimming Option	Triac / DALI / 0-10V			
Sensor	-			
Emergency Kits	-			
Electrical Class	Class II			
Ingress Protection (IP Rating)	IP40			
Impact Resistance (IK Rating)	IK06			
Product Finishing(Base)	White RAL 9016			
Materials of Optics	PC			
Materials of Housing	PC+ABS / SPCC			
Lifetime (hr)	50,000h			
Glow wire test (°C)	850°C			
Operating Temp. (°C)	-20°C ~ 45°C			
Storage Temp. (°C)	-20°C ~ 65°C			
Installation	Pendant / Recessed			

Measurement

Code	Dimension(mm)			Size(mm)	Product Weight (Kg)		Package weight (Kg)		Carton Size(cm)	Qty/CTN	20GP (pcs)	40HQ (pcs)
	A	B	C		N.W/PC	G.W/PC	N.W/CTN	G.W/CTN				
6060	595	595	23.5	595*595*23.5	3.5	3.9	14	16.1	68*26*71.5	4	888	2040
6262	620	620	23.5	620*620*23.5	3.65	4.15	14.6	17.2	72.5*26*74	4	856	1920
30120	295	1195	23.5	295*1195*23.5	3.55	4	14.2	16.5	128*26*41.5	4	744	1944
60120	595	1195	23.5	595*1195*23.5	6.8	7.5	13.6	16	130.5*13.5*73.5	2	432	972

Driver Datasheet (Non-Dimmable)

Total load wattage		35W	60W
Output	Output Voltage range	DC28-40V	DC30-40V
	Rated output current	900mA	1500mA
	Line Regulation	±5%	
	Setup, Rise Time	<0.5S@230V	
	Flickering Index	<80%	0.5% (NO RISK)
Input	Input Voltage	AC230V	
	Rated Input Voltage(V)	AC220-240V	
	Frequency	50/60Hz	
	Input Current	≤0.19A	≤0.34A
	Rated Input Current	0.16A	0.31A
	Power Factor	0.9	
	THD	<20% @ 230V	
	Efficiency	>86%	90%
No load wattage	<1W @230V	<0.5W @230V	
Protection	Short circuit protection	Pass	
	Overvoltage protection	Pass	
	Overtemperature protection	Pass	
Safety & EMC	Withstand voltage	I/P-O/P:3.75KVac,<5mA 60S	
	Isolation Resistance	/P-O/P: 500VDC, ≥100M Ω	
	Inrush Current	IEC61000-4-5(L-N:1KV)	
	EMC Emission	EN55015, EN61000-3-2	
	EMC Immunity	EN61000-4-2,3,4,5,6,8,11; EN61547	

Driver Datasheet (Triac Dimmable)

Total load wattage		35W
Output	Output Voltage range	DC23-40V
	Rated output current	800mA
	Line Regulation	±5%
	Setup, Rise Time	<1S
	Flickering Index	<10%
Input	Input Voltage	AC230V
	Rated Input Voltage(V)	AC200-240V
	Frequency	50Hz
	Input Current	≤0.2A
	Rated Input Current	0.17A
	Power Factor	0.9
	THD	<20% @ 230V
	Efficiency	>85%
No load wattage		<1W
Protection	Short circuit protection	Pass
	Over voltage protection	Pass
	Over temperature protection	Pass
Safety & EMC	Withstand voltage	I/P-O/P:3.75KVac,<5mA 60S
	Isolation Resistance	I/P-O/P: 500VDC, ≥100M Ω
	Inrush Current	IEC61000-4-5(L-N:1KV, L/N-PG:2KV)
	EMC Emission	EN55015, EN61000-3-2
EMC Immunity		EN61000-4-2,3,4,5,6,8,11; EN61547

Installation Procedure

WARNING ⚡

- 1.Switch off before installation / maintenance.
- 2.Switch on only after complete installation and examination of the circuit.
- 3.Professional electrician for installation and maintenance only.



■ Recessed into ceiling (1)

Step 1

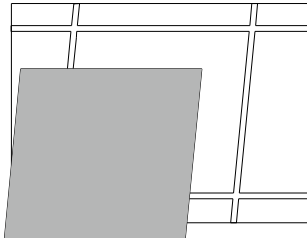

Remove ceiling plaster slab.

Step 2

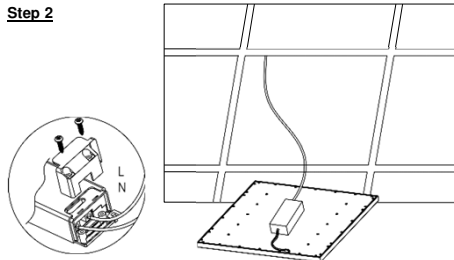

Feed the main AC wire in driver terminal block respectively,connect the panel light and driver.

Step 3

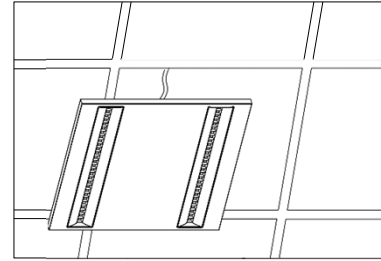

Fix the panel light to the plaster ceiling.

Step 4

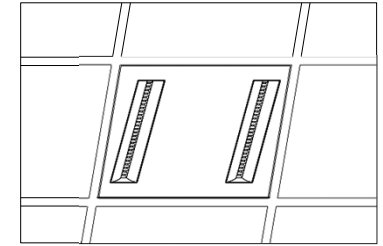

Make sure the led panel light is firmly fixed,turn on the power..

■ Recessed into ceiling (2)

Step 1

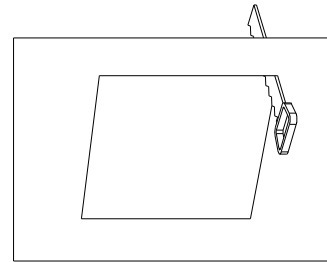

Open a hole according to the cutout size.

Step 2

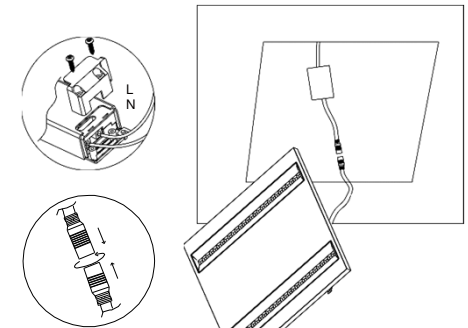

Feed the main AC wire in driver terminal block respectively,connect the panel light and driver.

Step 3

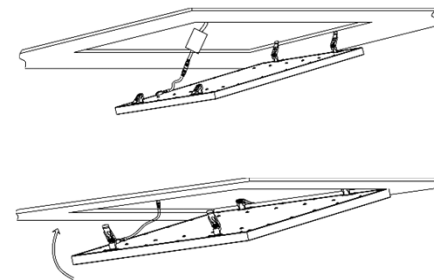

Fasten one side of clips with the ceiling. Fasten the other side of clips.

Step 4

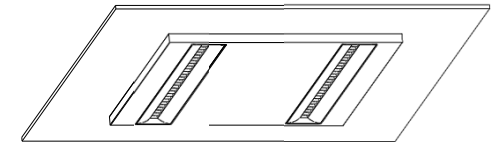

Turn on the power, installation completed.

Suspending

Step 1

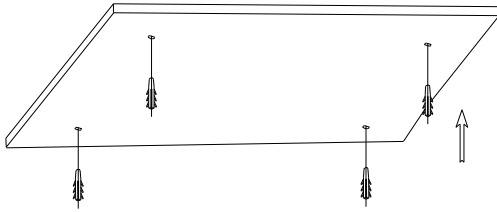

Fix the anchor into target place on the ceiling.

Step 2

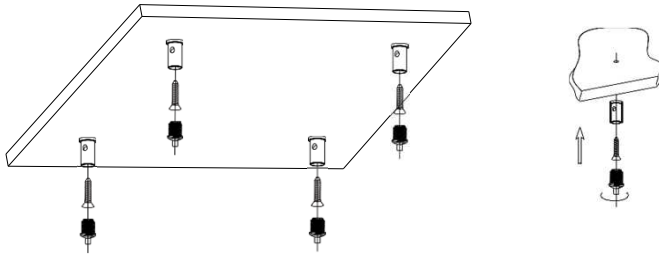

Fix the installation mount on the ceiling with plastic anchor.

Step 3

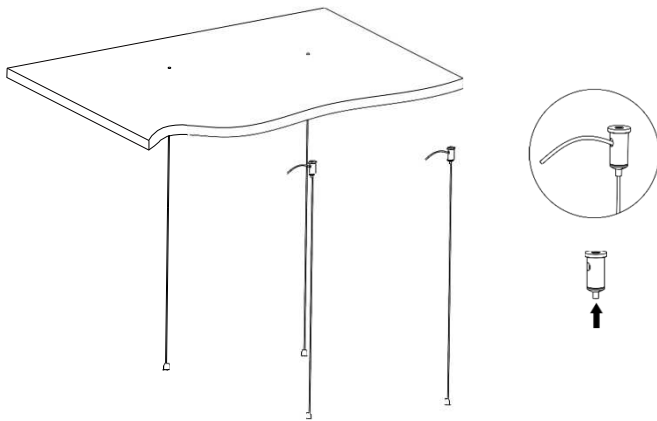

Hang the panel to ceiling with suspended installation kits, adjust the length of steel wires.

Step 4

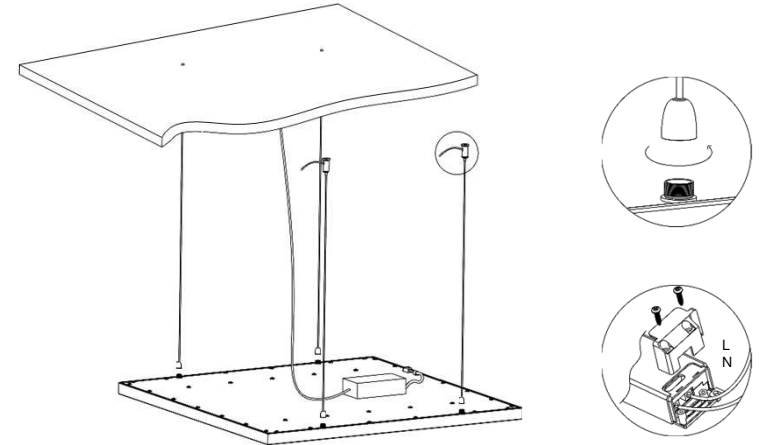

Feed the main AC wire in driver terminal block respectively, turn on the power.

Step 5

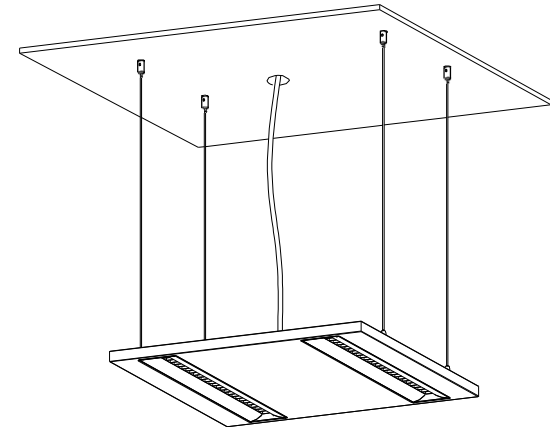



RL Europe
Your partner in LED

www.rleurope.ch

info@rleurope.ch

TEL: +41 (0)91 6832255

Add: via E. Bossi 12/B, CH-6830 Chiasso (TI)